

Crop Consultant

C O N F E R E N C E

IN COLLABORATION WITH

SEPTEMBER 27 - 28, 2023

VISALIA CONVENTION CENTER



**CERTIFIED
CROP ADVISER
WESTERN REGION**

EXHIBITOR INFORMATION

TENTATIVE SCHEDULE

SEPTEMBER 27, 2023

BREAKFAST AND TRADE SHOW: 7:00AM – 8:00AM
SESSIONS: 8:00AM – 10:00AM
BREAK AND TRADE SHOW: 10:00AM – 11:00AM
SESSIONS: 11:00AM – 12:00PM
LUNCH: 12:00PM – 1:00PM
SESSIONS: 1:00PM – 3:00PM
BREAK AND TRADE SHOW: 3:00PM – 4:00PM
SESSIONS: 4:00PM – 5:00PM
MIXER: 5:00PM – 6:00PM

SEPTEMBER 28, 2023

BREAKFAST AND TRADE SHOW: 7:00AM – 8:00AM
SESSIONS: 8:00AM – 10:00AM
BREAK AND TRADE SHOW: 10:00AM – 11:00AM
SESSIONS: 11:00AM – 12:00PM
LUNCH: 12:00PM – 1:00PM
SESSIONS: 1:00PM – 2:30PM



Dear Exhibitor,

On behalf of our team, I would like to thank you for choosing to exhibit at our 2023 Crop Consultant Conference, hosted by **Progressive Crop Consultant Magazine** and co-hosted by **Western Region Certified Crop Advisers**.

Enclosed you will find information for the conference. Please refer to this exhibitor kit regarding staff registration, move-in / move-out information, digital guide ad, liability insurance certificate, tote bag items and order options for electricity not included with your booth package.

We also reserved a block of rooms for the conference and partnered with the following hotels for those who need overnight accommodation:

- [Visalia Marriott at the Convention Center,](#)
- [Comfort Suites Visalia Convention Center](#) and
- [The Darling Hotel.](#)

We look forward to seeing you at the conference.

Sincerely,

Jason Scott

Jason Scott | Publisher

VISALIA CONVENTION CENTER

303 E ACEQUIA AVE, VISALIA, CA 93291

Crop Consultant
CONFERENCE

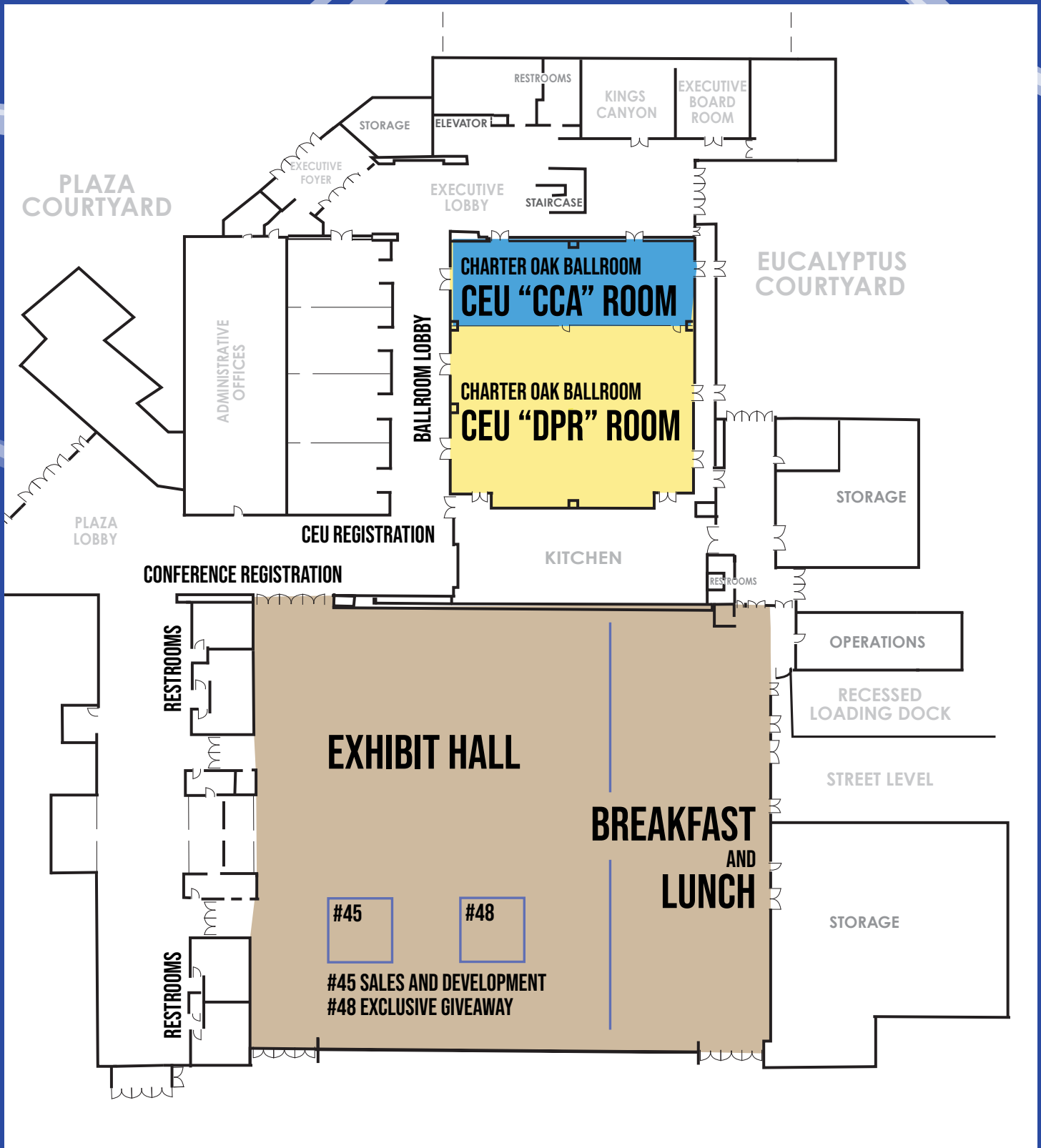

NEW! REGISTER YOUR EXHIBIT STAFF

You asked and we listened! Your exhibit comes with 2 complimentary registrations, register your exhibit staff today to save time at check-in. Use the individuals' own email addresses as those will be needed for their on-line CEU sessions:

<https://myaglife.com/exhibitor-event-registration/>

MOVE-IN

September 26, 2023 noon – 5PM

SHOW HOURS

September 27, 2023 7AM – 6:00PM and September 28, 2023 7AM – 1:00PM

MOVE-OUT

September 28, 2023 1:00PM – 4:00PM

ELECTRICITY due by **SEPTEMBER 15, 2023**

If you need electricity at your exhibit, place your order on-line:

<https://mediakit.jcsmarketinginc.com/product/crop-consultant-conference/>

CERTIFICATE OF LIABILITY INSURANCE due by **AUGUST 28, 2023**

All exhibitors are required to have Comprehensive General Liability Insurance of not less than \$1,000,000 for bodily injury and/or property damage, with the following listed as additionally insured: JCS Marketing, Inc., Crop Consultant Conference and Visalia Convention Center. While all exhibitors are required to have this insurance coverage, only those exhibitors with booths larger than a 10x10 booth must provide proof of a copy of that insurance by uploading the certificate of insurance by the due date.

Exhibitors who fail to provide proof of insurance will not be allowed to move-in until coverage is provided. Sample certificate of insurance to send to your insurance company is included in this document.

Upload <https://www.wcngg.com/upload-proof-of-insurance/>

TOTE BAG ITEM due by **AUGUST 28, 2023**

Mail/deliver: JCS Marketing Inc., Attn: Jay Visser, 8469 N. Millbrook Ave, Suite 101, Fresno, CA 93720

DIGITAL AD AND DIGITAL SPONSOR FILE due by **SEPTEMBER 15, 2023**

Specs for digital ad: 8.5in by 11in vertical digital file in RGB format, resolution set at min. 72dpi, 792px by 612px, full color, full page, digital ad, no crop/registration marks necessary. Will be sent in "thank you" email following the conference. Upload digital ads and sponsor files <https://mediakit.jcsmarketinginc.com/advertiser-upload/>

ARE YOU A PCA / CCA / CONSULTANT AND NEED CEU HOURS?

Your exhibit comes with 2 complimentary conference registrations, which provide access to both in-person and on-line CEU sessions. In-person sessions: sign-in each morning at CEU registration desk, attend sessions and receive Certificate of Completion at the end of each day. On-line sessions: obtain login information, complete sessions at your own pace and receive Certificate of Completion upon successful completion of each on-line CEU session; available until December 31, 2023.

QUESTIONS ABOUT YOUR SPONSORSHIP / EXHIBITING?

Call our office (559) 352-4456 or email Rita Edwards rita@jcsmarketinginc.com

ON-SITE POINT OF CONTACT

Jay Visser (559) 289-1980 and Rita Edwards (916) 792-2308

HOST HOTEL OPTIONS

[VISALIA MARRIOTT AT THE CONVENTION CENTER](#) 559-636-1111 – please use the embedded link to the reservation portal to receive our negotiated discount rate.

[COMFORT SUITES VISALIA CONVENTION CENTER](#) 559-738-1700 – please ask for Crop Consultant Conference when calling to receive our negotiated discount rate.

[THE DARLING HOTEL](#) 559-713-2113 – please ask for Crop Consultant Conference when calling to receive our negotiated discount rate.



CERTIFICATE OF INSURANCE SAMPLE

Crop Consultant
CONFERENCE



CERTIFICATE OF LIABILITY INSURANCE

DATE (MM/DD/YYYY)
CURRENT DATE

THIS CERTIFICATE IS ISSUED AS A MATTER OF INFORMATION ONLY AND CONFERS NO RIGHTS UPON THE CERTIFICATE HOLDER. THIS CERTIFICATE DOES NOT AFFIRMATIVELY OR NEGATIVELY AMEND, EXTEND OR ALTER THE COVERAGE AFFORDED BY THE POLICIES BELOW. THIS CERTIFICATE OF INSURANCE DOES NOT CONSTITUTE A CONTRACT BETWEEN THE ISSUING INSURER(S), AUTHORIZED REPRESENTATIVE OR PRODUCER, AND THE CERTIFICATE HOLDER.

IMPORTANT: If the certificate holder is an ADDITIONAL INSURED, the policy(ies) must have ADDITIONAL INSURED provisions or be endorsed. If SUBROGATION IS WAIVED, subject to the terms and conditions of the policy, certain policies may require an endorsement. A statement on this certificate does not confer rights to the certificate holder in lieu of such endorsement(s).

PRODUCER INSURANCE AGENT NAME AND ADDRESS	CONTACT NAME:	
	PHONE (A/C, No, Ext):	FAX (A/C, No):
INSURED INSURED NAME AND ADDRESS	E-MAIL ADDRESS:	
	PRODUCER CUSTOMER ID:	
	INSURER(S) AFFORDING COVERAGE	NAIC #
	INSURER A:	INSURANCE COMPANY NAME
	INSURER B:	
	INSURER C:	
	INSURER D:	
	INSURER E:	
	INSURER F:	

COVERAGES CERTIFICATE NUMBER: W02036242 REVISION NUMBER:

THIS IS TO CERTIFY THAT THE POLICIES OF INSURANCE LISTED BELOW HAVE BEEN ISSUED TO THE INSURED NAMED ABOVE FOR THE POLICY PERIOD INDICATED. NOTWITHSTANDING ANY REQUIREMENT, TERM OR CONDITION OF ANY CONTRACT OR OTHER DOCUMENT WITH RESPECT TO WHICH THIS CERTIFICATE MAY BE ISSUED OR MAY PERTAIN, THE INSURANCE AFFORDED BY THE POLICIES DESCRIBED HEREIN IS SUBJECT TO ALL THE TERMS, EXCLUSIONS AND CONDITIONS OF SUCH POLICIES. LIMITS SHOWN MAY HAVE BEEN REDUCED BY PAID CLAIMS.

INSR LTR	TYPE OF INSURANCE	ADDL BNSD	SUBR WVD	POLICY NUMBER	POLICY EFF (MM/DD/YYYY)	POLICY EXP (MM/DD/YYYY)	LIMITS	MINIMUM LIMITS
A	<input checked="" type="checkbox"/> COMMERCIAL GENERAL LIABILITY <input type="checkbox"/> CLAIMS-MADE <input checked="" type="checkbox"/> OCCUR MUST BE SELECTED GEN'L AGGREGATE LIMIT APPLIES PER: <input type="checkbox"/> POLICY <input type="checkbox"/> PROJECT <input type="checkbox"/> LOC OTHER:	X		POLICY NUMBER		CURRENT POLICY PERIOD MUST COVER	EACH OCCURRENCE DAMAGE TO RENTED PREMISES (Ea Occurrence) MED EXP (Any one person) PERSONAL & ADV INJURY GENERAL AGGREGATE PRODUCTS - COMPIOP AGG PROFESSIONAL LIABILITY LEGAL LIAB TO PARTICIPANTS	\$1,000,000 \$1,000,000 \$5,000 \$1,000,000 \$2,000,000 \$1,000,000
	AUTOMOBILE LIABILITY <input type="checkbox"/> ANY AUTO <input type="checkbox"/> OWNED AUTOS ONLY <input type="checkbox"/> SCHEDULED AUTOS <input type="checkbox"/> HIRED AUTOS ONLY <input type="checkbox"/> NON-OWNED AUTOS ONLY NOT PROVIDED WHILE IN HAWAII						COMBINED SINGLE LIMIT (Ea accident) BODILY INJURY (Per person) BODILY INJURY (Per accident) PROPERTY DAMAGE (Per accident)	
	<input type="checkbox"/> UMBRELLA LIAB <input type="checkbox"/> OCCUR <input type="checkbox"/> EXCESS LIAB <input type="checkbox"/> CLAIMS-MADE <input type="checkbox"/> DED <input type="checkbox"/> RETENTION						EACH OCCURRENCE AGGREGATE	
	WORKERS COMPENSATION AND EMPLOYERS' LIABILITY ANY PROPRIETOR/PARTNER/ EXECUTIVE OFFICER/MEMBER EXCLUDED? (Mandatory in NH) <input type="checkbox"/> Y / N If yes, describe under DESCRIPTION OF OPERATIONS below	N/A					<input type="checkbox"/> PER STATUTE <input type="checkbox"/> OTHER E.L. EACH ACCIDENT E.L. DISEASE - EA EMPLOYEE E.L. DISEASE - POLICY LIMIT	
	MEDICAL PAYMENTS FOR PARTICIPANTS						PRIMARY MEDICAL EXCESS MEDICAL	

DESCRIPTION OF OPERATIONS / LOCATIONS / VEHICLES (ACORD 101, Additional Remarks Schedule, may be attached if more space is required)

JCS MARKETING, INC.
ADD EVENT NAME, DATES AND ENDORSEMENT FORM# - FORM TO BE ATTACHED
THIS INSURANCE SHALL BE PRIMARY AND NON-CONTRIBUTORY.

CERTIFICATE HOLDER	CANCELLATION
JCS Marketing, Inc. P.O. Box 27772 Fresno, CA 93729	SHOULD ANY OF THE ABOVE DESCRIBED POLICIES BE CANCELLED BEFORE THE EXPIRATION DATE THEREOF, NOTICE WILL BE DELIVERED IN ACCORDANCE WITH THE POLICY PROVISIONS.
	AUTHORIZED REPRESENTATIVE
	SIGNATURE

POLICY NUMBER: **POLICY NUMBER**

COMMERCIAL GENERAL LIABILITY
CG 20 26 04 13

THIS ENDORSEMENT CHANGES THE POLICY. PLEASE READ IT CAREFULLY.

ADDITIONAL INSURED – DESIGNATED PERSON OR ORGANIZATION

This endorsement modifies insurance provided under the following:

COMMERCIAL GENERAL LIABILITY COVERAGE PART

SCHEDULE

Name Of Additional Insured Person(s) Or Organization(s)

JCS Marketing, Inc. P.O. Box 27772 Fresno, CA 93729

Information required to complete this Schedule, if not shown above, will be shown in the Declarations.

A. Section II – Who Is An Insured is amended to include as an additional insured the person(s) or organization(s) shown in the Schedule, but only with respect to liability for "bodily injury", "property damage" or "personal and advertising injury" caused, in whole or in part, by your acts or omissions or the acts or omissions of those acting on your behalf:

1. In the performance of your ongoing operations; or
2. In connection with your premises owned by or rented to you.

However:

1. The insurance afforded to such additional insured only applies to the extent permitted by law; and
2. If coverage provided to the additional insured is required by a contract or agreement, the insurance afforded to such additional insured will not be broader than that which you are required by the contract or agreement to provide for such additional insured.

B. With respect to the insurance afforded to these additional insureds, the following is added to **Section III – Limits Of Insurance**:

If coverage provided to the additional insured is required by a contract or agreement, the most we will pay on behalf of the additional insured is the amount of insurance:

1. Required by the contract or agreement; or
2. Available under the applicable Limits of Insurance shown in the Declarations;

whichever is less.

This endorsement shall not increase the applicable Limits of Insurance shown in the Declarations.